



Ultra thin stepper

R&D / Engineering Headquarters

NIDEC SERVO CORPORATION

1. KV2810 _ Outline Dimensions

Connector: JST
 Housing: PHR-4
 Contact: SPH-002T-P0.5S

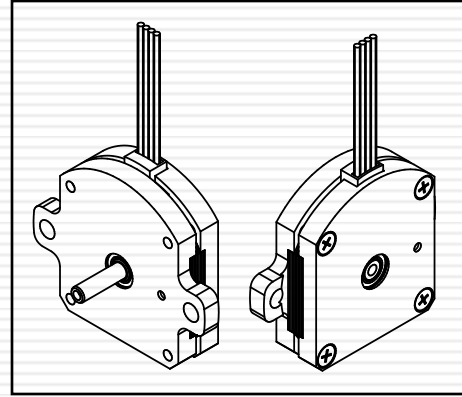
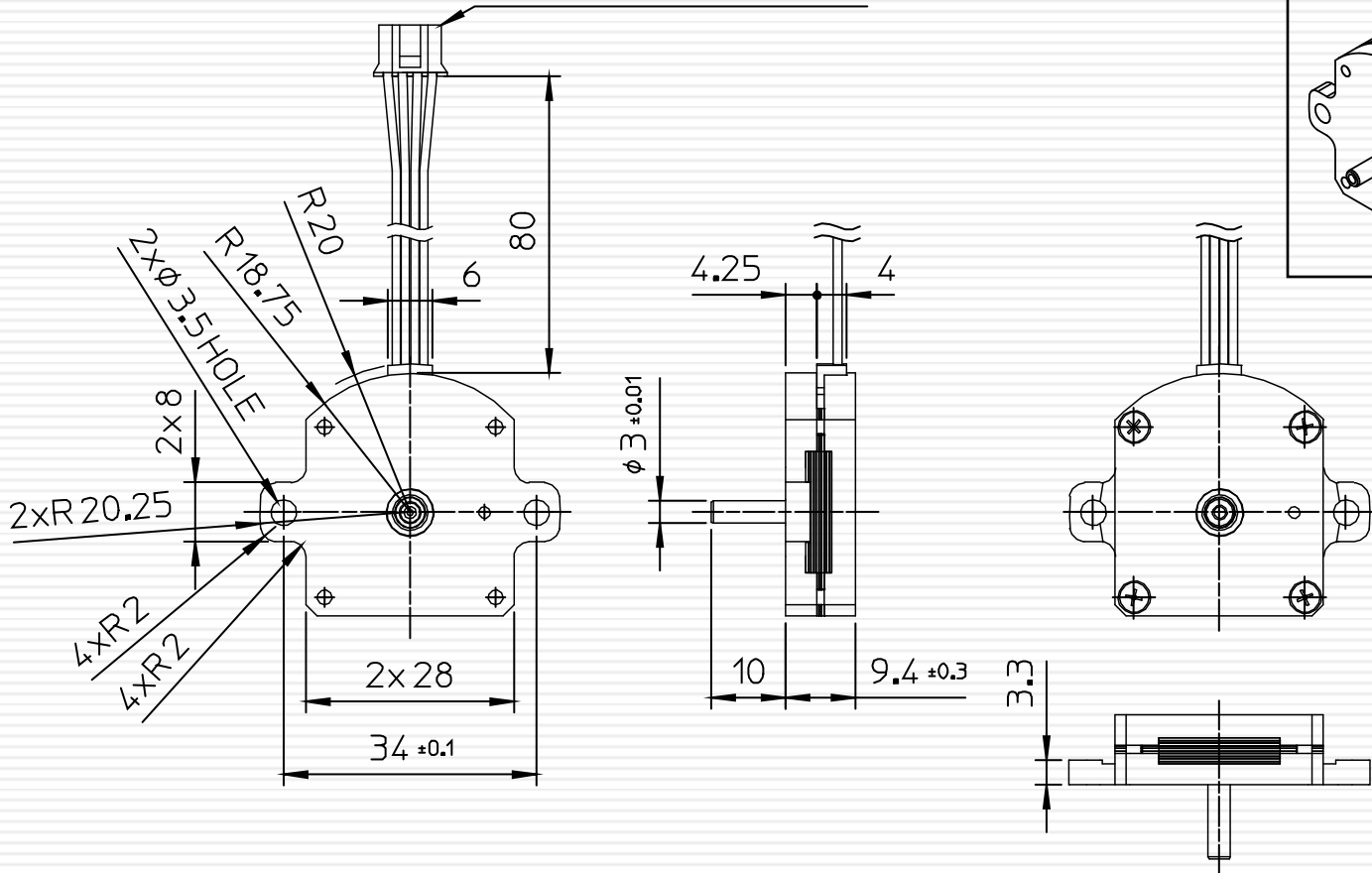

**Prototype can be easily customized according to your company's needs.
 Please tell us the shape or specification that it is easy to use in your company.**

2. KV2810 _ Torque curve

KV2810

Step angle: 1.8 degree
Magnet: Nd-Fe-B
Winding method: Bipolar
Resistance: 3.2 ohm

Driving condition

Driving circuit: Servo original
Voltage: DC 24 V
Current: 1 A / Phase
Excitation: 2 phase (Full stepping)

NOTE: This winding spec is for the intermittent driving.

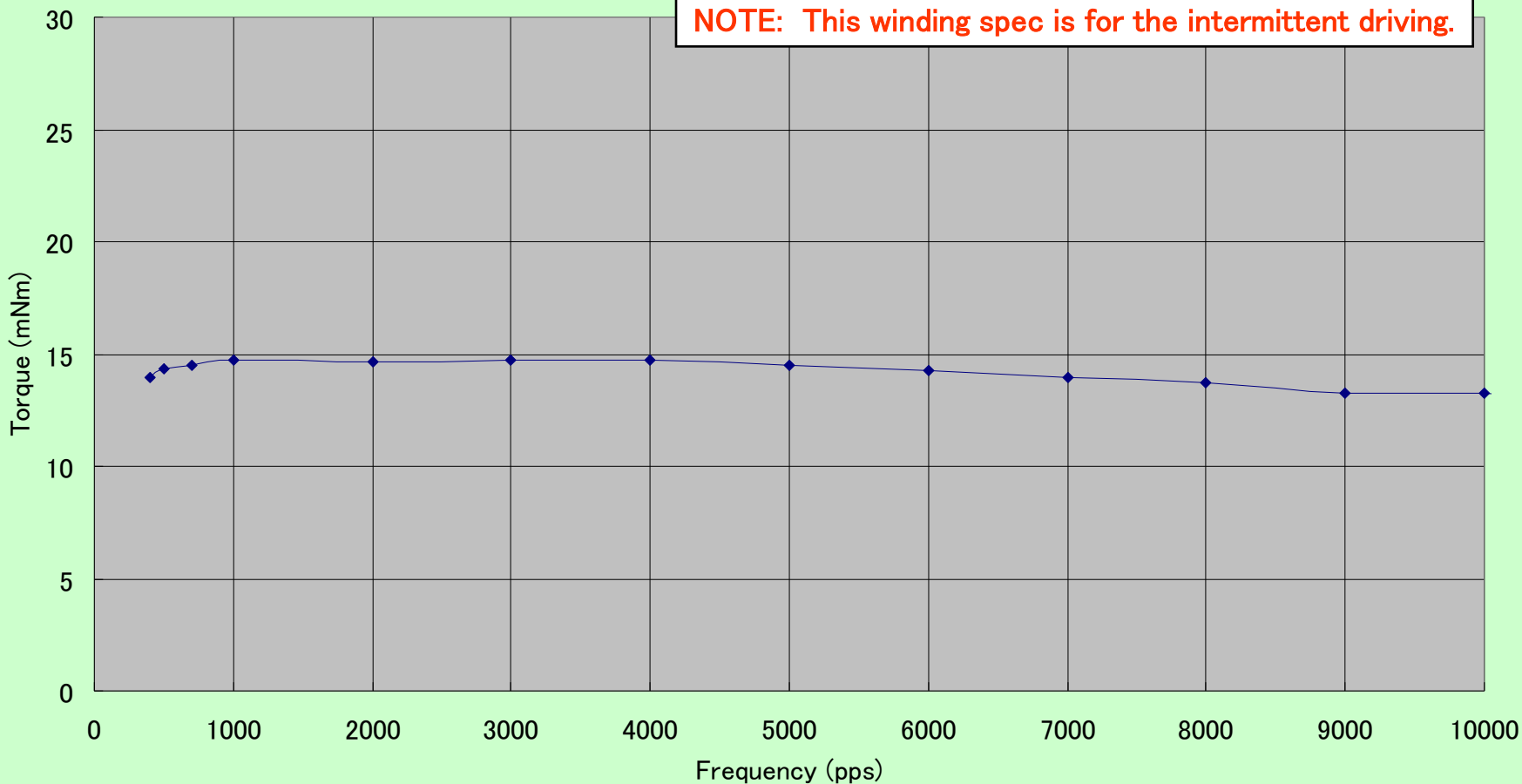

3. KA5910 _ Outline Dimensions

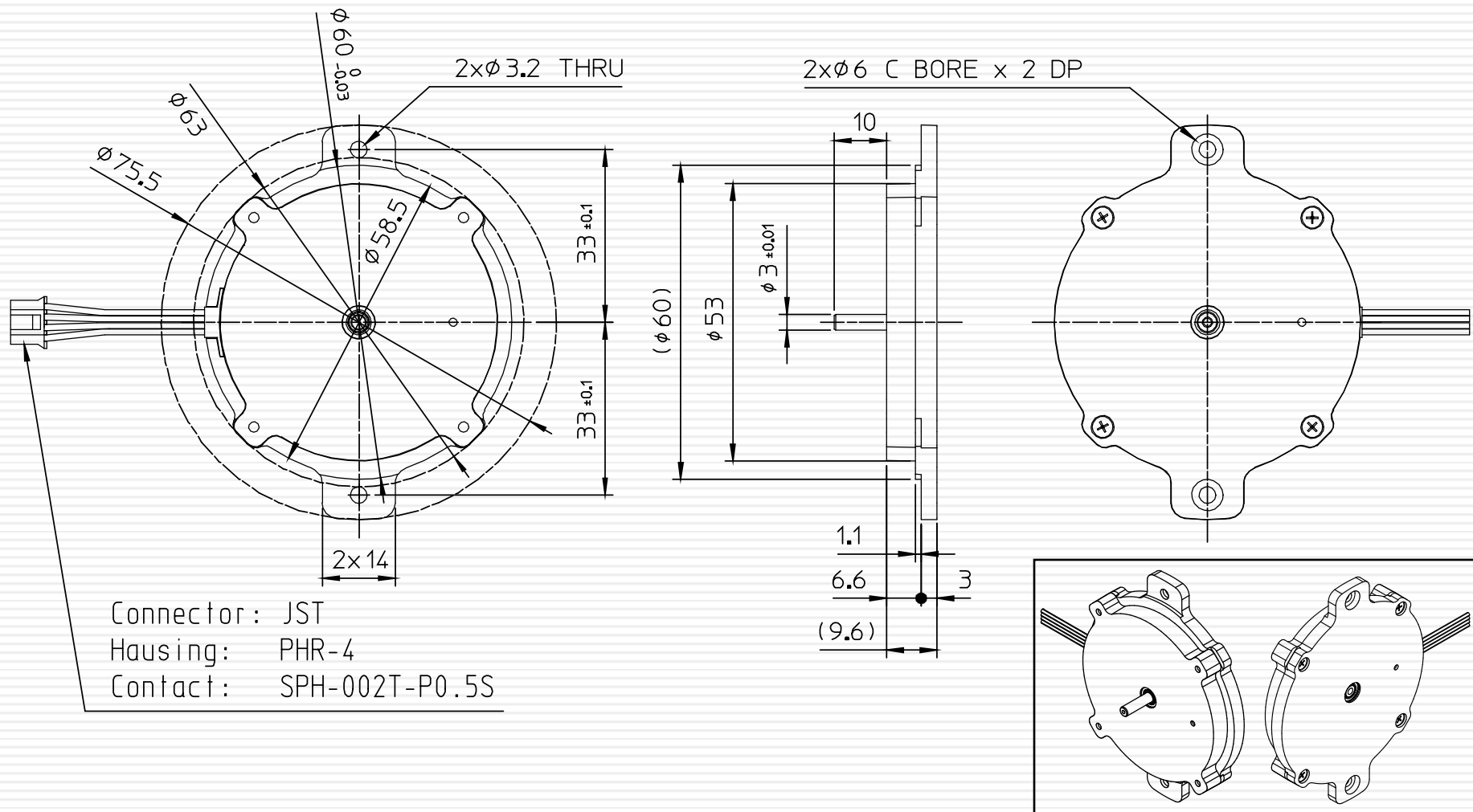

**Prototype can be easily customized according to your company's needs.
 Please tell us the shape or specification that it is easy to use in your company.**

4. KA5910 _ Torque curve

KA5910

Step angle: 1.8 degree
 Magnet: Nd-Fe-B
 Winding method: Bipolar
 Resistance: 3.0 ohm

Driving condition

Driving circuit: Servo original
 Voltage: DC 24 V
 Current: 1 A / Phase
 Excitation: 2 phase (Full stepping)

NOTE: This winding spec is for the intermittent driving.

